



AGENDA

Wednesday, December 6, 2023

Location: Omni Oklahoma City Hotel, 100 W. Oklahoma City Blvd, Oklahoma City OK 73109

Attendees: NASWA Veterans Affairs Committee members and invited guests

7:30 a.m. – 8:30 a.m. **Breakfast Buffet** PINON – LEVEL 2

8:30 a.m. – 8:50 a.m. **Welcome & Member/Guest Introductions** ROUTE 66 – LEVEL 2

- **Sarah Morrissey**, Chair, Employment Services Bureau Director, New Hampshire Employment Security

8:50 a.m. – 9:00 a.m. **Review of Agenda & Meeting Materials** ROUTE 66 – LEVEL 2

- **Lori Adams**, Senior Policy Director, National Association of State Workforce Agencies

9:00 a.m. – 10:15 a.m. **VETS Policy & Program Updates (via TEAMS)** ROUTE 66 – LEVEL 2



- **Brandon Webb**, NVTI Lead, USDOL VETS
- **Bek Haydin**, JVSG Governance Lead, USDOL VETS
- **Maria Temiquel**, Director, Grants and Training, USDOL VETS
- **Matt Heaney**, Atlanta Regional Administrator, USDOL VETS
- **Heather Higgins**, Dallas & Chicago Regional Administrator, USDOL VETS (invited)
- **Other DOL VETS staff as available**

10:15 a.m. – 10:30 a.m. **Break** PINON – LEVEL 2

10:30 a.m. – Noon  **State Spotlight: Oklahoma** ROUTE 66 – LEVEL 2

- **Cody Cox**, Director of Field Operations, Oklahoma Employment Security Department

- **Shelley Zumwalt**, Executive Director, Oklahoma Tourism & Recreation Department
- **Trae Rahill**, Chief Executive Officer, Oklahoma Employment Security Commission

Noon – 1:00 p.m.	Lunch Buffet	PINON – LEVEL 2
1:15 p.m. – 2:00 p.m.	<p>Promising Practice – Washington (via TEAMS)</p> <p>Compassion Fatigue Awareness</p> <p><i>Our customers depend on caring, in-depth assistance from our front-line teams more than ever before. Over time, this intense support impacts the health and well-being of the individuals who are providing the help. Compassion fatigue comes on slow and can be difficult to recognize. To keep providing the very best service to our customers, it's important for our team members to understand compassion fatigue and take steps to build their own support systems. Please join us for an introduction to compassion fatigue provided by one of our own service delivery professionals who has experienced compassion fatigue firsthand during military deployments to the Middle East as well as after his return home.</i></p> <ul style="list-style-type: none"> • Monty Webb, DVOP, Washington State Employment Security Department, Joint Base Lewis McChord 	ROUTE 66 – LEVEL 2
2:00 p.m. – 2:30 p.m.	<p>NASWA Update & Legislative Priorities</p> <ul style="list-style-type: none"> • Scott Sanders/Julie Squire 	ROUTE 66 – LEVEL 2
2:30 p.m. – 2:50 p.m.	Break	PINON – LEVEL 2
2:50 p.m. – 3:30 p.m.	<p>Vet Conference Debrief</p> <ul style="list-style-type: none"> • Lori Adams & group 	ROUTE 66 – LEVEL 2
3:30 p.m. – 5:00 p.m.	<p>Strategic Planning Breakouts (Committee Members Only)</p> <ul style="list-style-type: none"> • <i>Marketing- Tim Rockefeller, CT, lead</i> • <i>Expanding DVOP Eligibility – Ray Douha, MN, lead</i> • <i>Serving Veterans with Disabilities – Kevin Welch, TN, lead</i> 	ROUTE 66 – LEVEL 2
Meeting Adjourned	Dinner on Your Own	

Thursday, December 7, 2023 National Pearl Harbor Remembrance Day

7:30 a.m. – 8:30 a.m.	Breakfast Buffet	PINON – LEVEL 2
8:30 a.m. – 9:30 a.m.	Strategic Priorities Work Groups <ul style="list-style-type: none">• Committee Members Only<ul style="list-style-type: none">○ <i>Each group will report on out what was discussed on Thursday</i>	ROUTE 66 – LEVEL 2
9:30 a.m.-10:00 a.m.	Break & Time to Check Out of Hotel	PINON – LEVEL 2
10:00 a.m. – 11:30 a.m.	Committee Member Roundtable <ul style="list-style-type: none">• Everyone – <i>please come prepared to share what is going on in your state! This includes people joining via MS Teams. If you are leaving early, please send an update to Lori to share with the group..</i>	ROUTE 66 – LEVEL 2
11:30 a.m.	Meeting Adjourns <i>Safe travels!</i>	

Note: All times listed are **Central Daylight Time.**
Masks are not required; social distancing is still encouraged

Mark Your Calendars!

- **Monthly Virtual Committee Meetings on TEAMS, 10:30 a.m.-12 noon EST, October 12, 2023; November 26, 2023. No call in December because of in-person meeting.**
- **Eleventh Annual Veterans Conference, August 7-9, 2024, The Grand Hyatt, Washington DC**

Hotel Floor Plan

Meeting and meal rooms are on Level 2

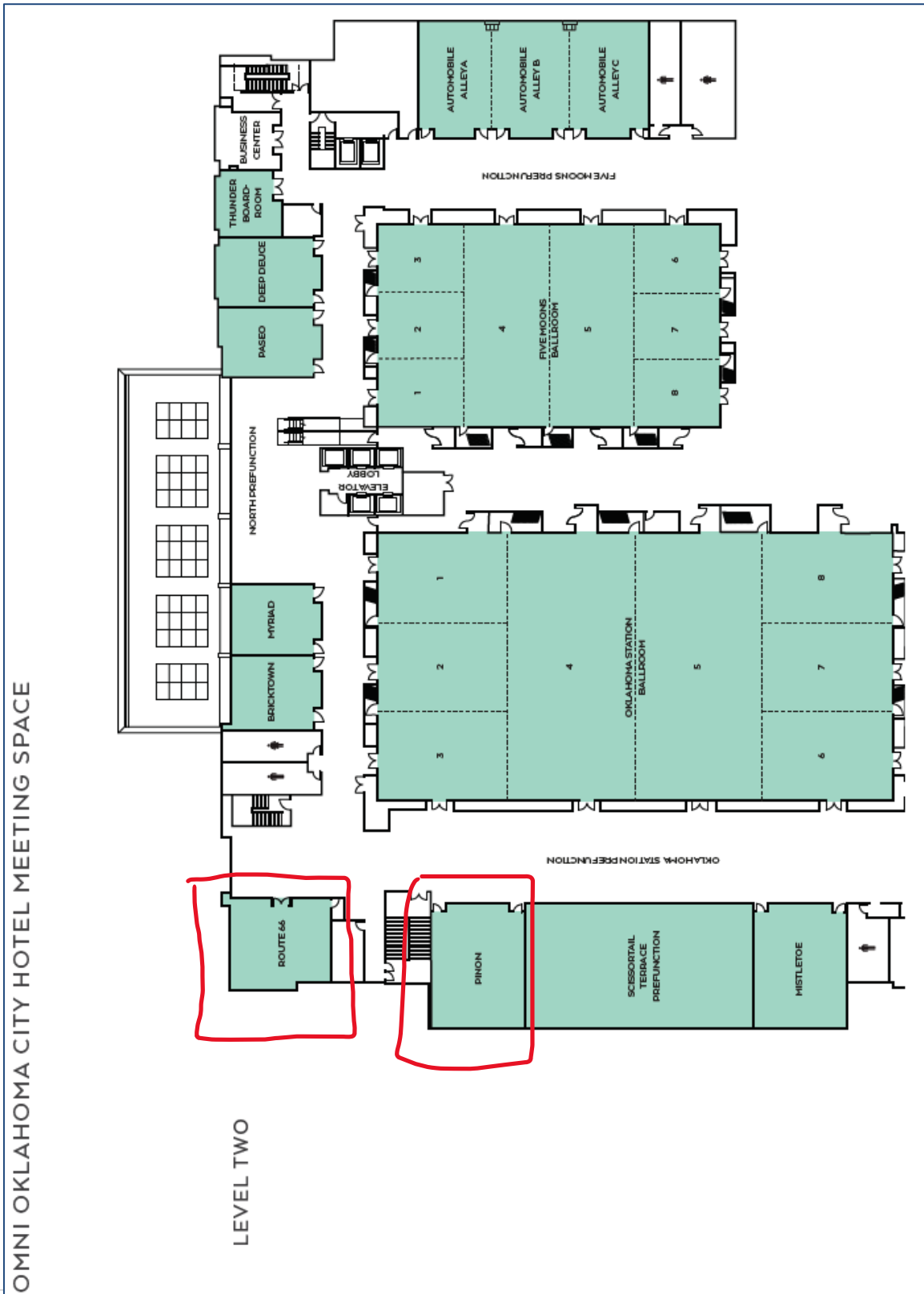

Travel Information

According to Google Maps, the hotel is about 10 miles, or 15-19 minutes away from [Will Rogers World Airport](#) by car. Obviously that will depend on traffic! The hotel is about a 20 minute walk from the [Oklahoma City National Memorial Museum](#), which is a very moving tribute to the lives lost in the 1995 Murrah federal building bombing. Bring your military ID for a discounted ticket.

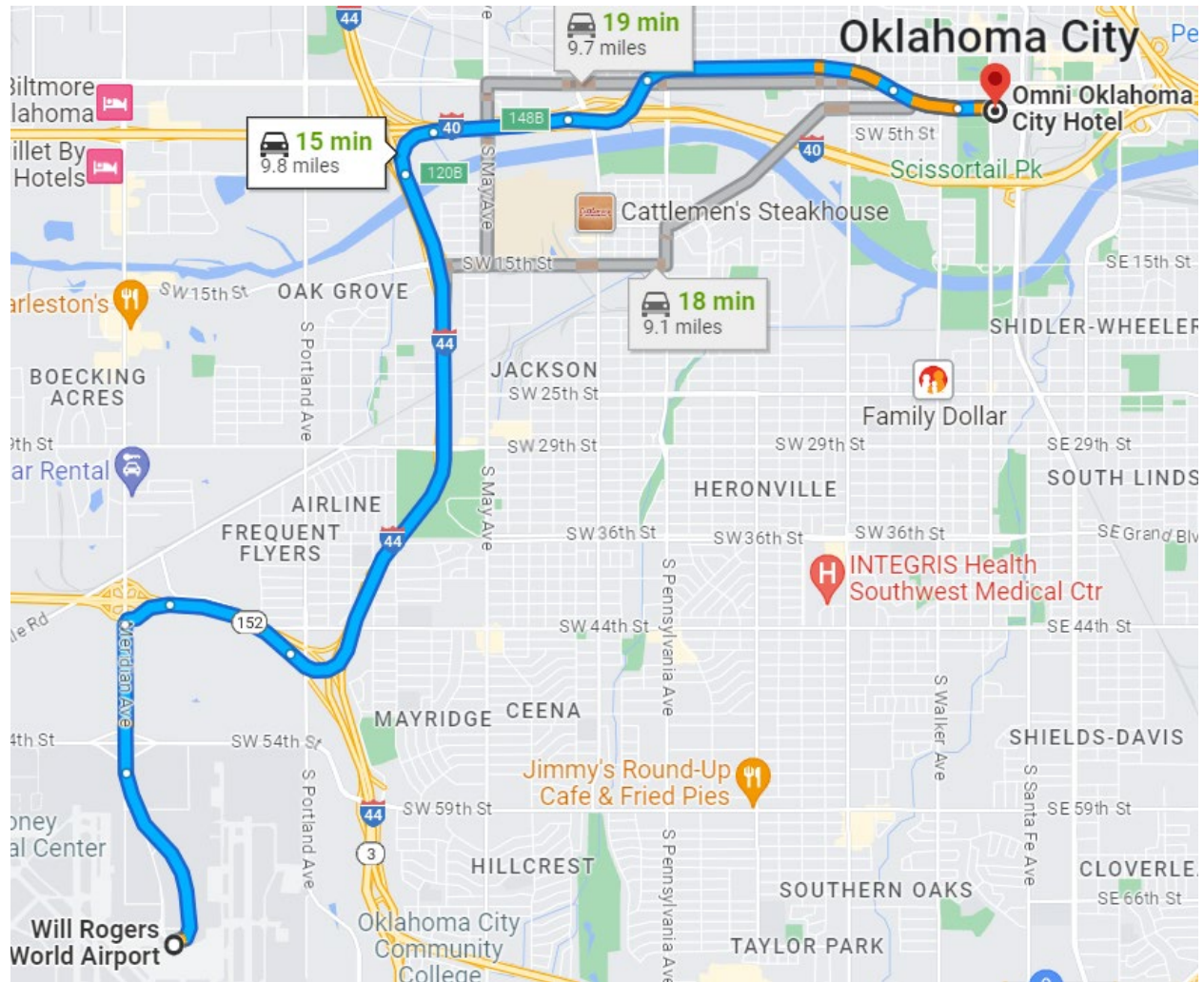

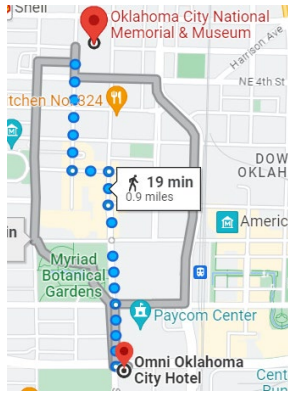

Ground Transportation

TAXI /TNC'S (UBER, LYFT)/LIMO

Taxis are located in the Transportation Plaza which is accessed from the baggage claim (lower) level. Prices vary among companies and minimum fares may be charged. Rates are posted on the exterior of the vehicles. There is no obligation to take the first taxi or shuttle in line.

The TNC (Uber, Lyft) pickup area is on the upper level "Departures" roadway at the west end. The area is marked as "TNC Pick Up".

Limousines and Charters must be scheduled through individual agencies.

VAN / SHUTTLES

Public and Private Vans are on site to meet all scheduled flights and transport incoming passengers. Prices vary among companies and minimum fares may be charged. Rates are posted on the exterior of the vehicles. There is no obligation to take the first shuttle in line. To arrange for pickup from home, business or hotel, reservations must be made prior to departure. Information on rates and reservations can be obtained by calling each company directly.

AIRPORT EXPRESS

405-681-3311

www.airportexpressokc.com

Visit website for fares and to book your ride online or call (405) 681-3311 / Toll Free (877) 688-3311.

You can also email feedback to feedback@airportexpressokc.com.

MARRIOTT AT THE NCED

For reservations call:

1-800-682-4560

The United States Postal Service National Center for Employee Development (NCED) provides private van transportation to and from the airport and the NCED Conference Center and Hotel. The service is

available only to NCED and hotel guests. A continuous shuttle runs every Sunday from 11 AM until Midnight. Arrivals and departures on other days than Sunday must be scheduled. This shuttle is for guests of the NCED Conference Center and Hotel only.

DISABILITY SERVICES

405-685-8267

MedRide is located in Oklahoma City and provides wheelchair and special needs transportation. For rates and reservations call 405-685-8267 or check the website at www.medride.com.